

**Tax Map
12
HERMON
MAINE**



LEGEND

- PROPERTY LINE
- EASEMENT
- PUBLIC RIGHT-OF-WAY
- PRIVATE RIGHT-OF-WAY
- RAILROAD RIGHT-OF-WAY
- BUILDING FOOTPRINT
- HISTORIC LOT LINE
- PARCEL HOOK
- STREET NUMBER
- 125 PARCEL NUMBER
- 1858 ACCOUNT NUMBER
- 150' SURVEY DIMENSION (FT)
- 2 SURVEY LOT NUMBER
- WETLAND
- HYDROLOGY

This map is prepared for the inventory of real property within the Town of Hermon and is compiled from recorded deeds, plats, tax maps, surveys, planimetric maps, and other public records and data. Users of this tax map are hereby notified that the aforementioned public primary information sources should be consulted for verification of the information contained on this map. The Town of Hermon and its mapping contractors assume no legal responsibility for the information contained herein.

SCALE: 1:2,400



		58	59	60	61
52	53	54	55	56	57
45	46	47	48	49	50
38	39	40	41	42	43
31	32	33	34	35	36
24	25	26	27	28	29
17	18	19	20	21	22
10	11	12	13	14	15
	4	5	6	7	8
	1	2	3		

Map Index

Original map created by J. W. Sewall, Company
Map updated by the Town of Hermon.

Assessment Date: April 1, 2023
Print Date: 6/14/2024

Hermon Assessor's Office
333 Billings Road
Hermon, ME 04401
(207) 848-1010

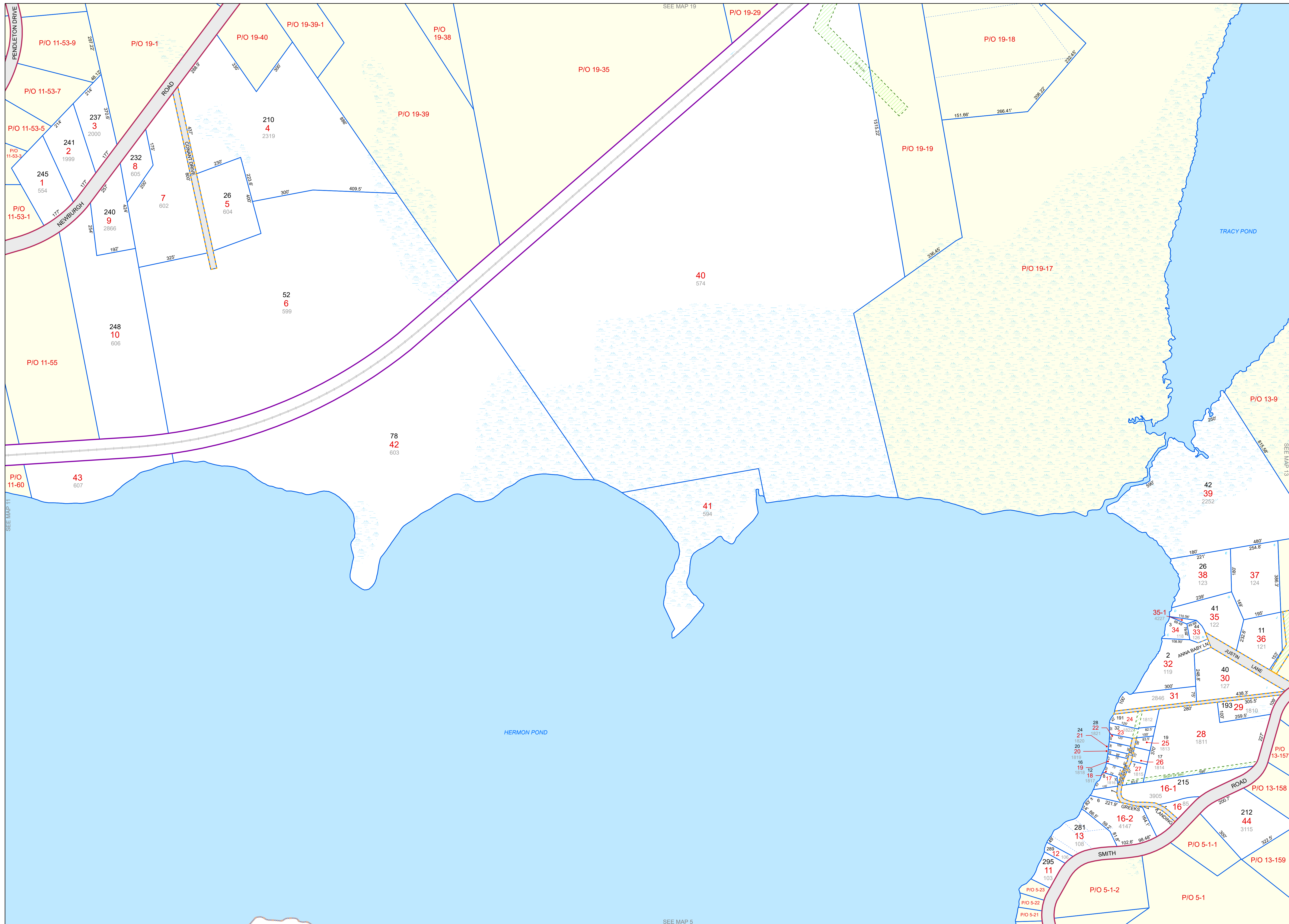

SEE MAP 19

P/O 19-29

40
574

52
6

78
42

41
594

42
39

2252

26
38

41
35

11
36

40
30

31

28

25

26

16-1

16-2

13

11

212
44

SEE MAP 5

SEE MAP 11

SEE MAP 13