

**Tax Map
6
HERMON
MAINE**



LEGEND

- PROPERTY LINE
- EASEMENT
- PUBLIC RIGHT-OF-WAY
- PRIVATE RIGHT-OF-WAY
- RAILROAD RIGHT-OF-WAY
- BUILDING FOOTPRINT
- HISTORIC LOT LINE
- PARCEL HOOK
- 224** STREET NUMBER
- 125** PARCEL NUMBER
- 1858** ACCOUNT NUMBER
- 150'** SURVEY DIMENSION (FT)
- 2** SURVEY LOT NUMBER
- WETLAND
- HYDROLOGY

This map is prepared for the inventory of real property within the Town of Hermon and is compiled from recorded deeds, plats, tax maps, surveys, planimetric maps, and other public records and data. Users of this tax map are hereby notified that the aforementioned public primary information sources should be consulted for verification of the information contained on this map. The Town of Hermon and its mapping contractors assume no legal responsibility for the information contained herein.

SCALE: 1:2,400



	58	59	60	61		
52	53	54	55	56	57	
45	46	47	48	49	50	51
38	39	40	41	42	43	44
31	32	33	34	35	36	37
24	25	26	27	28	29	30
17	18	19	20	21	22	23
10	11	12	13	14	15	16
4	5	6	7	8	9	
1	2	3				

Map Index

Original map created by J. W. Sewall, Company
Map updated by the Town of Hermon.

Assessment Date: April 1, 2023
Print Date: 6/14/2024

Hermon Assessor's Office
333 Billings Road
Hermon, ME 04401
(207) 848-1010

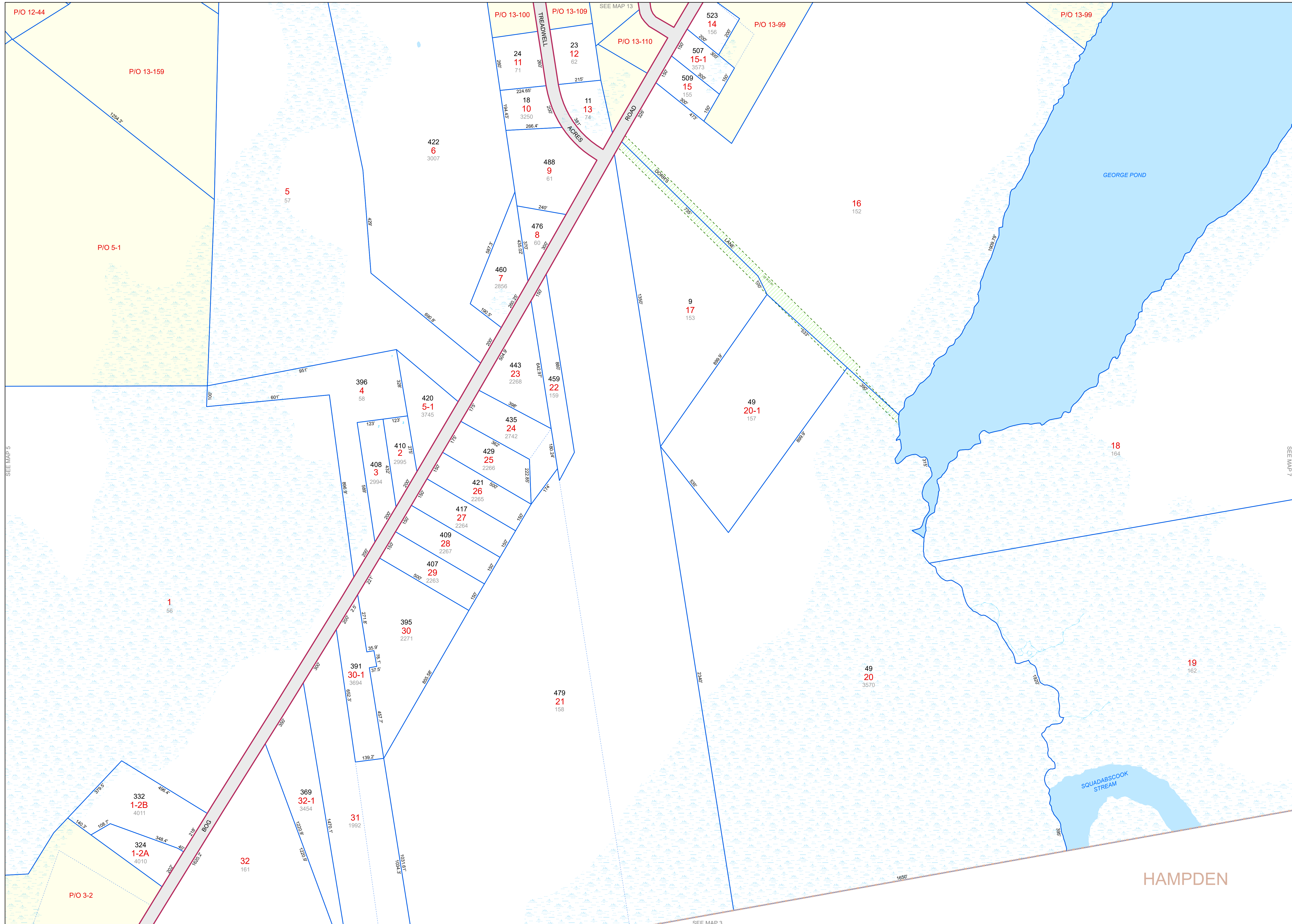

SEE MAP 5

SEE MAP 3

SEE MAP 7

HAMPDEN